



SMD Shielded Power Inductors - HCDS Series

FEATURES

- * RoHS, Halogen Free and REACH Compliance
- * Magnetic shielded
- * Various package size and wide inductance range

ORDERING CODE(标志示例)

HCDS □□□□ - □□□ □

(1) (2) (3) (4)

- (1) HCDS 向华料号 Part Number
- (2) 尺寸 Dimensions
- (3) 电感量 Inductance
- (4) 电感量公差 Inductance Tolerance

Shape and Dimensions

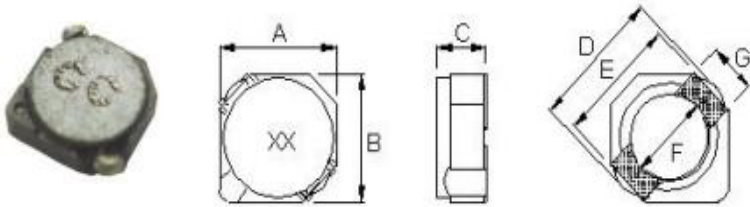

Recommended Pattern

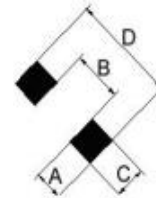

Dimensions in mm

Dimensions in mm

TYPE	Shape and Dimensions							Recommended Pattern			
	A	B	C	D	E	F	G	A	B	C	D
HCDS2D11	3.2 ⁺⁰	3.2 ⁺⁰	1.20 ⁺⁰	4.5 ⁺⁰	3.30	2.10	1.0	1.3	1.7	1.3	4.3
HCDS2D14	3.2 ⁺⁰	3.2 ⁺⁰	1.55 ⁺⁰	4.5 ⁺⁰	3.30	2.10	1.0	1.3	1.7	1.3	4.3
HCDS2D18	3.2 ⁺⁰	3.2 ⁺⁰	2.00 ⁺⁰	4.5 ⁺⁰	3.30	2.10	1.0	1.3	1.7	1.3	4.3

Shape and Dimensions

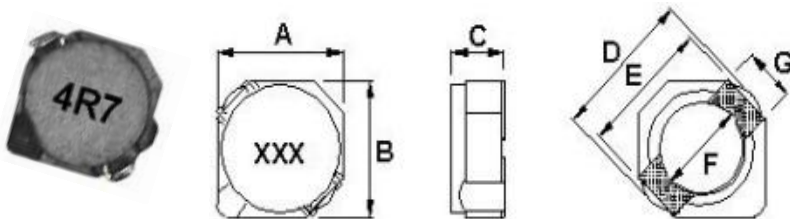

Recommended Pattern

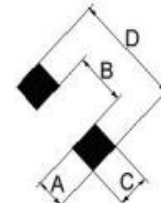

Dimensions in mm

Dimensions in mm

TYPE	Shape and Dimensions							Recommended Pattern			
	A	B	C	D	E	F	G	A	B	C	D
HCDS3D11	4 ⁺⁰	4 ⁺⁰	1.2 ⁺⁰	5.2 ⁺⁰	4.40	2.80	1.1	1.4	2.4	1.5	5.2



SMD Shielded Power Inductors - HCDS Series

Shape and Dimensions

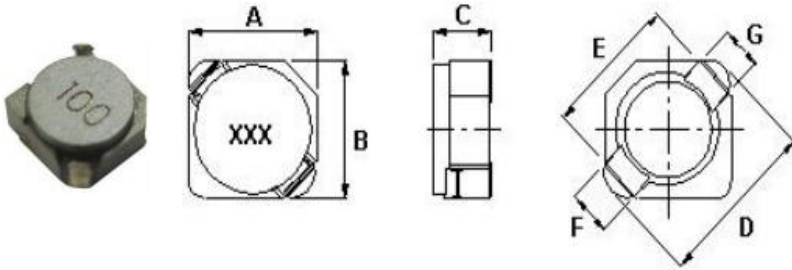

Recommended Pattern

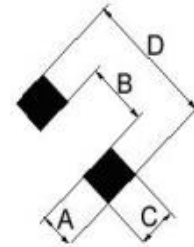

Dimensions in mm

TYPE	Shape and Dimensions							Recommended Pattern			
	A	B	C	D	E	F	G	A	B	C	D
HCDS3D16	4 ⁺⁰	4 ⁺⁰	1.8 ⁺⁰	5.2 ⁺⁰	4.40	1.4 ⁺⁰	1.1	1.4	2.4	1.5	5.2

Dimensions in mm

Shape and Dimensions

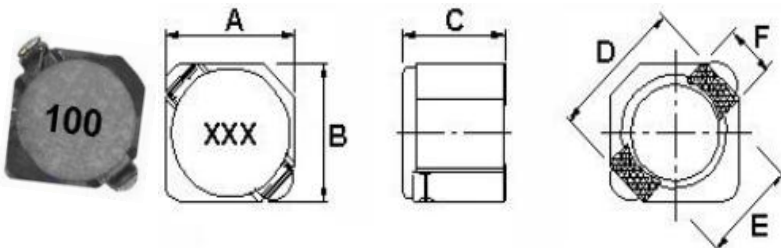

Recommended Pattern

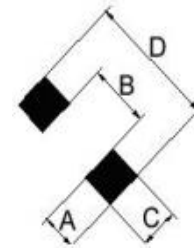

Dimensions in mm

TYPE	Shape and Dimensions						Recommended Pattern			
	A	B	C	D	E	F	A	B	C	D
HCDS3D28	4 ⁺⁰	4 ⁺⁰	3 ⁺⁰	4.4	2.80	1.10	1.4	2.4	1.5	5.2

Dimensions in mm



SMD Shielded Power Inductors - HCDS Series

FEATURES

- * RoHS, Halogen Free and REACH Compliance
- * Magnetic shielded
- * Various package size and wide inductance range

ORDERING CODE(标志示例)

HCDS □□□□ - □□□ □

(1) (2) (3) (4)

- (1) HCDS 向华料号 Part Number
- (2) 尺寸 Dimensions
- (3) 电感量 Inductance
- (4) 电感量公差 Inductance Tolerance

Shape and Dimensions

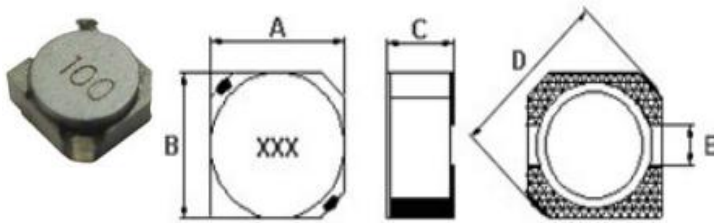

Dimensions in mm

TYPE	A	B	C	D	E
HCDS3D16	4.0 ⁺⁰	4.0 ⁺⁰	1.8 ⁺⁰	5.2 ⁺⁰	1.00

Recommended Pattern

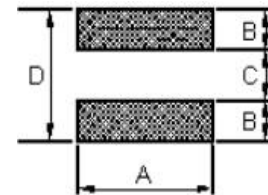

Dimensions in mm

TYPE	A	B	C	D
HCDS3D16	4.6	1.6	1.4	4.6

Shape and Dimensions

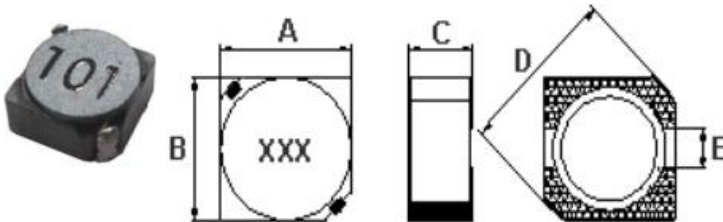

Dimensions in mm

TYPE	A	B	C	D	E
HCDS4D18	4.7±0.3	4.7±0.3	2.0 ⁺⁰	6.9 ⁺⁰	1.50
HCDS4D28	4.7±0.3	4.7±0.3	3.0 ⁺⁰	6.9 ⁺⁰	1.50
HCDS4D40	4.7±0.3	4.7±0.3	4.0 ⁺⁰	6.9 ⁺⁰	1.50
HCDS5D18	5.7±0.3	5.7±0.3	2.0 ⁺⁰	8.2 ⁺⁰	2.00
HCDS5D28	5.7±0.3	5.7±0.3	3.0 ⁺⁰	8.2 ⁺⁰	2.00
HCDS6D28	6.7±0.3	6.7±0.3	3.0 ⁺⁰	9.5 ⁺⁰	2.00
HCDS6D38	7 ⁺⁰	7 ⁺⁰	4.0 ⁺⁰	9.5 ⁺⁰	2.00

Recommended Pattern

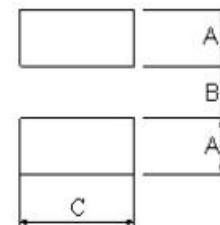

Dimensions in mm

TYPE	A	B	C
HCDS4D18	1.9	1.5	5.3
HCDS4D28	1.9	1.5	5.3
HCDS4D40	1.9	1.5	5.3
HCDS5D18	2.15	2.0	6.3
HCDS5D28	2.15	2.0	6.3
HCDS6D28	2.65	2.0	7.3
HCDS6D38	2.65	2.0	7.3



SMD Shielded Power Inductors - HCDS Series

FEATURES

- * RoHS, Halogen Free and REACH Compliance
- * Magnetic shielded
- * Various package size and wide inductance range

ORDERING CODE(标志示例)

HCDS □□□□ - □□□ □
(1) (2) (3) (4)

- (1) HCDS 向华料号 Part Number
- (2) 尺寸 Dimensions
- (3) 电感量 Inductance
- (4) 电感量公差 Inductance Tolerance

Shape and Dimensions

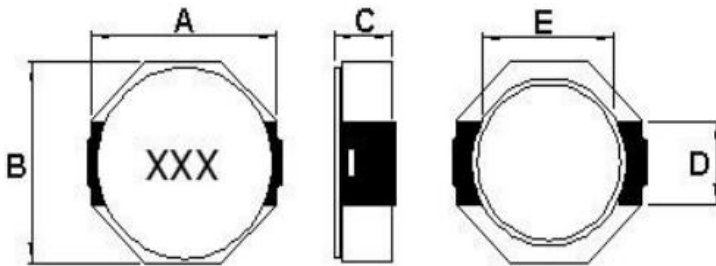

Recommended Pattern

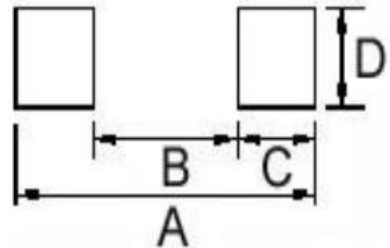

Dimensions in mm

TYPE	A	B	C	D	E
HCDS8D43	8.3 ⁺⁰	8.3 ⁺⁰	4.5 ⁺⁰	2.5	6.30

Dimensions in mm

TYPE	A	B	C	D
HCDS8D43	10.1	6.1	2.0	2.8



SMD Shielded Power Inductors - HCDS2D11 Series

HCDS2D11 series Electrical Characteristics

Part No.	Inductance	Tolerance	Test Freq.	RDC(mΩ)	Isat(A)	Irms	Marking
	(uH)	(±%)		max	Max(Typ.)	(A)Typ.	
HCDS2D11T-1R5□	1.5	30	100KHz,1V	68	0.72(0.97)	1.48	BF
HCDS2D11T-2R2□	2.2	20,30	100KHz,1V	98	0.60(0.78)	1.27	CC
HCDS2D11T-3R3□	3.3	30	100KHz,1V	155	0.46(0.60)	1.02	DD
HCDS2D11T-3R9□	3.9	30	100KHz,1V	160	0.44(0.55)		DJ
HCDS2D11T-4R7□	4.7	20,30	100KHz,1V	170	0.40(0.50)	0.68	EH
HCDS2D11T-6R8□	6.8	30	100KHz,1V	260	0.33(0.45)	0.80	GI
HCDS2D11T-100□	10	20,30	100KHz,1V	400	0.28(0.35)	0.65	KA
HCDS2D11T-150□	15	20,30	100KHz,1V	600	0.20(0.28)		MA
HCDS2D11T-220□	22	20,30	100KHz,1V	950	0.18(0.24)		LA

Note: When ordering, please specify tolerance code. Tolerance: M=±20% , T=±30%

- Operating temperature range – 30°C ~ 100°C (Including self - temperature rise)
- Isat for Inductance drop 35% from its value with current
- Irms for a 40°C temperature rise from 25°C ambient.
- RDC test method: place testing device to the 2 solder ends of winding and test the value.



SMD Shielded Power Inductors - HCDS2D14 Series

HCDS2D14 series Electrical Characteristics

Part No.	Inductance	Tolerance	Test Freq.	RDC(mΩ)	Isat(A)	Irms	Marking
	(uH)	(±%)		max	Max(Typ.)	(A)Typ.	
HCDS2D14T-R47□	0.47	30	100KHz,1V	40	2.00(2.80)		AO
HCDS2D14T-1R5□	1.5	30	100KHz,1V	63	1.40(1.80)	2.00	BF
HCDS2D14T-1R8□	1.8	30	100KHz,1V	75	1.30(1.70)	1.80	BI
HCDS2D14T-2R2□	2.2	30	100KHz,1V	94	1.20(1.60)	1.60	CC
HCDS2D14T-2R7□	2.7	30	100KHz,1V	106	1.10(1.40)	1.40	CH
HCDS2D14T-3R3□	3.3	30	100KHz,1V	125	0.95(1.20)	1.24	DD
HCDS2D14T-3R9□	3.9	20,30	100KHz,1V	138	0.92(1.10)	1.12	DJ
HCDS2D14T-4R1□	4.1	20,30	100KHz,1V	169	0.80(1.00)	1.00	EA
HCDS2D14T-4R7□	4.7	20,30	100KHz,1V	169	0.80(1.00)	1.00	EH
HCDS2D14T-5R6□	5.6	20,30	100KHz,1V	188	0.76(0.95)	0.98	FG
HCDS2D14T-6R8□	6.8	20,30	100KHz,1V	213	0.71(0.88)	0.92	GI
HCDS2D14T-8R2□	8.2	20,30	100KHz,1V	281	0.64(0.80)	0.80	IC
HCDS2D14T-100□	10	20,30	100KHz,1V	294	0.57(0.72)	0.76	KA
HCDS2D14T-120□	12	20,30	100KHz,1V	394	0.52(0.65)	0.64	QA

Note: When ordering, please specify tolerance code. Tolerance: M=±20% , T=±30%

- Operating temperature range—30°C~100°C(Including self - temperature rise)
- Isat for Inductance drop 35% from its value with current
- I rms for a 40°C temperature rise from 25°C ambient.
- RDC test method: place testing device to the 2 solder ends of winding and test the value.



SMD Shielded Power Inductors - HCDS2D18LD Series

HCDS2D18LD series Electrical Characteristics

Part No.	Inductance	Tolerance	Test Freq.	RDC(mΩ)	Isat(A)	Irms	Marking
	(uH)	(±%)		max	Max(Typ.)	(A)Typ.	
HCDS2D18LD-2R2□	2.2	20,30	100KHz,1V	41	0.85(1.10)	2.30	CC
HCDS2D18LD-3R3□	3.3	20,30	100KHz,1V	54	0.75(0.95)	2.10	DD
HCDS2D18LD-4R7□	4.7	20,30	100KHz,1V	78	0.63(0.78)	1.65	EH
HCDS2D18LD-6R8□	6.8	20,30	100KHz,1V	106	0.52(0.65)	1.32	GI
HCDS2D18LD-100□	10	20,30	100KHz,1V	180	0.43(0.53)	1.00	KA
HCDS2D18LD-150□	15	20,30	100KHz,1V	220	0.35(0.45)	0.80	MA
HCDS2D18LD-220□	22	20,30	100KHz,1V	320	0.30(0.36)	0.68	LA
HCDS2D18LD-330□	33	20,30	100KHz,1V	460	0.24(0.31)	0.56	NA
HCDS2D18LD-390□	39	20,30	100KHz,1V	600	0.21(0.28)		PA
HCDS2D18LD-470□	47	20,30	100KHz,1V	660	0.19(0.24)	0.48	OA

Note: When ordering, please specify tolerance code. Tolerance: M=±20% , T=±30%

- Operating temperature range—30°C~100°C(Including self - temperature rise)
- Isat for Inductance drop 35% from its value with current
- Irms for a 40°C temperature rise from 25°C ambient.
- RDC test method: place testing device to the 2 solder ends of winding and test the value.

**SMD Shielded Power Inductors - HCDS2D18HP Series****HCDS2D18HP series Electrical Characteristics**

Part No.	Inductance	Tolerance	Test Freq.	RDC(mΩ)	Isat(A)	Irms	Marking
	(uH)	(±%)		max	Max(Typ.)	(A)Typ.	
HCDS2D18HP-1R5□	1.5	30	100KHz,1V	50	1.90(2.40)	2.20	BF
HCDS2D18HP-1R7□	1.7	20,30	100KHz,1V	50	1.85(2.40)	2.20	BH
HCDS2D18HP-2R2□	2.2	20,30	100KHz,1V	60	1.60(2.30)	1.90	CC
HCDS2D18HP-3R3□	3.3	20,30	100KHz,1V	97	1.45(1.80)	1.55	DD
HCDS2D18HP-4R7□	4.7	20,30	100KHz,1V	140	1.00(1.50)	1.20	EH
HCDS2D18HP-6R3□	6.3	20,30	100KHz,1V	180	0.96(1.30)	1.15	GD
HCDS2D18HP-6R8□	6.8	20,30	100KHz,1V	195	0.95(1.20)	1.10	GI
HCDS2D18HP-100□	10	20,30	100KHz,1V	285	0.85(1.00)	0.90	KA
HCDS2D18HP-150□	15	20,30	100KHz,1V	410	0.67(0.83)	0.64	MA
HCDS2D18HP-220□	22	20,30	100KHz,1V	650	0.50(0.67)	0.60	LA

Note: When ordering, please specify tolerance code. Tolerance: M=±20% , T=±30%

- Operating temperature range—30℃~100℃(Including self - temperature rise)
- Isat for Inductance drop 35% from its value with current
- Irms for a 40℃ temperature rise from 25℃ ambient.
- RDC test method: place testing device to the 2 solder ends of winding and test the value.



SMD Shielded Power Inductors - HCDS3D11 Series

HCDS3D11 series Electrical Characteristics

Part No.	Inductance	Tolerance	Test Freq.	RDC(mΩ)	Rated Current	Irms	Marking
	(uH)	(±%)		max	(A)	(A)Typ.	
HCDS3D11T-2R7□	2.7	30	100KHz,1V	78	0.53	1.82	2R7
HCDS3D11T-4R7□	4.7	20,30	100KHz,1V	123	0.40	1.38	4R7
HCDS3D11T-6R8□	6.8	30	100KHz,1V	180	0.34	1.05	6R8
HCDS3D11T-8R2□	8.2	30	100KHz,1V	204	0.32	0.93	8R2
HCDS3D11T-100□	10	20,30	100KHz,1V	240	0.28	0.90	100
HCDS3D11T-120□	12	20,30	100KHz,1V	276	0.25	0.81	120
HCDS3D11T-150□	15	20,30	100KHz,1V	372	0.23	0.68	150
HCDS3D11T-180□	18	20,30	100KHz,1V	468	0.21	0.58	180
HCDS3D11T-220□	22	20,30	100KHz,1V	540	0.19	0.53	220
HCDS3D11T-270□	27	20,30	100KHz,1V	726	0.17	0.48	270
HCDS3D11T-330□	33	20,30	100KHz,1V	822	0.15	0.41	330
HCDS3D11T-390□	39	20,30	100KHz,1V	942	0.14	0.40	390

Note: When ordering, please specify tolerance code. Tolerance: M=±20% , T=±30%

- Operating temperature range—30℃~100℃(Including self - temperature rise)
- Isat for Inductance drop 35% from its value with current
- I rms for a 40℃ temperature rise from 25℃ ambient.
- RDC test method: place testing device to the 2 solder ends of winding and test the value.



SMD Shielded Power Inductors - HCDS3D16S1 Series

HCDS3D16S1 series Electrical Characteristics

Part No.	Inductance	Tolerance	Test Freq.	RDC(mΩ)	Rated Current	Marking
	(uH)	(±%)		max	(A)	
HCDS3D16T-1R0□-S1	1.0	30	100KHz,1V	40	1.60	1R0
HCDS3D16T-1R5□-S1	1.5	30	100KHz,1V	52	1.55	1R5
HCDS3D16T-2R2□-S1	2.2	30	100KHz,1V	72	1.20	2R2
HCDS3D16T-3R3□-S1	3.3	30	100KHz,1V	85	1.10	3R3
HCDS3D16T-4R7□-S1	4.7	20,30	100KHz,1V	105	0.90	4R7
HCDS3D16T-5R6□-S1	5.6	30	100KHz,1V	135	0.80	5R6
HCDS3D16T-6R8□-S1	6.8	20,30	100KHz,1V	170	0.73	6R8
HCDS3D16T-8R2□-S1	8.2	20,30	100KHz,1V	210	0.55	8R2
HCDS3D16T-100□-S1	10	20,30	100KHz,1V	210	0.55	100
HCDS3D16T-150□-S1	15	30	100KHz,1V	295	0.45	150
HCDS3D16T-220□-S1	22	20,30	100KHz,1V	430	0.40	220
HCDS3D16T-330□-S1	33	30	100KHz,1V	675	0.32	330
HCDS3D16T-101□-S1	100	30	100KHz,1V	2750	0.13	101

Note: When ordering, please specify tolerance code. Tolerance: M=±20% , T=±30%

- Operating temperature range—30℃~100℃ (Including self - temperature rise)
- Isat for Inductance drop 35% from its value with current
- Irms for a 40℃ temperature rise from 25℃ ambient.
- RDC test method: place testing device to the 2 solder ends of winding and test the value.



SMD Shielded Power Inductors - HCDS3D28 Series

HCDS3D28 series Electrical Characteristics

Part No.	Inductance	Tolerance	Test Freq.	RDC(mΩ)	Rated Current	Irms	Marking
	(uH)	(±%)		max	(A)	(A)Typ.	
HCDS3D28T-1R0□	1.0	30	100KHz,1V	45	2.80	2.50	1R0
HCDS3D28T-3R3□	3.3	30	100KHz,1V	72.1	2.00	1.85	3R3
HCDS3D28T-4R7□	4.7	30	100KHz,1V	88.3	1.65	1.62	4R7
HCDS3D28T-6R8□	6.8	30	100KHz,1V	119	1.24	1.32	6R8
HCDS3D28T-100□	10	30	100KHz,1V	145	1.05	1.18	100
HCDS3D28T-150□	15	30	100KHz,1V	213	0.90	1.02	150
HCDS3D28T-220□	22	30	100KHz,1V	335	0.76	0.74	220
HCDS3D28T-330□	33	30	100KHz,1V	481	0.58	0.63	330
HCDS3D28T-470□	47	20,30	100KHz,1V	599	0.48	0.56	470

Note: When ordering, please specify tolerance code. Tolerance: M=±20% , T=±30%

- Operating temperature range – 30°C ~ 100°C (Including self - temperature rise)
- Isat for Inductance drop 35% from its value with current
- Irms for a 40°C temperature rise from 25°C ambient.
- RDC test method: place testing device to the 2 solder ends of winding and test the value.



SMD Shielded Power Inductors - HCDS3D28LD Series

HCDS3D28LD series Electrical Characteristics

Part No.	Inductance	Tolerance	Test Freq.	RDC(mΩ)	Rated Current	I _{rms}	Marking
	(uH)	(±%)		max	(A)	(A)Typ.	
HCDS3D28LD-100□	10	30	100KHz,1V	95	0.50	1.52	100
HCDS3D28LD-120□	12	30	100KHz,1V	100	0.45	1.48	120
HCDS3D28LD-150□	15	30	100KHz,1V	115	0.40	1.44	150
HCDS3D28LD-180□	18	30	100KHz,1V	125	0.35	1.37	180
HCDS3D28LD-220□	22	30	100KHz,1V	145	0.33	1.28	220
HCDS3D28LD-270□	27	30	100KHz,1V	175	0.29	1.18	270
HCDS3D28LD-330□	33	30	100KHz,1V	215	0.28	1.15	330
HCDS3D28LD-390□	39	30	100KHz,1V	225	0.25	1.00	390
HCDS3D28LD-470□	47	30	100KHz,1V	305	0.23	0.81	470
HCDS3D28LD-560□	56	30	100KHz,1V	325	0.20	0.76	560
HCDS3D28LD-680□	68	30	100KHz,1V	470	0.185	0.60	680
HCDS3D28LD-820□	82	30	100KHz,1V	540	0.172	0.58	820
HCDS3D28LD-101□	100	30	100KHz,1V	610	0.16	0.52	101
HCDS3D28LD-121□	120	30	100KHz,1V	755	0.136	0.50	121
HCDS3D28LD-151□	150	30	100KHz,1V	880	0.124	0.48	151
HCDS3D28LD-181□	180	30	100KHz,1V	1130	0.119	0.42	181
HCDS3D28LD-221□	220	30	100KHz,1V	1270	0.116	0.36	221

Note: When ordering, please specify tolerance code. Tolerance: M=±20% , T=±30%

- Operating temperature range -30°C ~ 100°C (Including self - temperature rise)
- I_{sat} for Inductance drop 35% from its value with current
- I_{rms} for a 40°C temperature rise from 25°C ambient.
- RDC test method: place testing device to the 2 solder ends of winding and test the value.



SMD Shielded Power Inductors - HCDS3D16 Series

HCDS3D16 series Electrical Characteristics

Part No.	Inductance	Tolerance	Test Freq.	RDC(mΩ)	Isat(A)	Marking
	(uH)	(±%)		max	Max(Typ.)	
HCDS3D16T-1R0□	1.0	30	100KHz,0.1V	40	1.35(1.70)	1R0
HCDS3D16T-1R5□	1.5	30	100KHz,0.1V	52	1.25(1.60)	1R5
HCDS3D16T-2R2□	2.2	30	100KHz,0.1V	72	1.00(1.30)	2R2
HCDS3D16T-3R3□	3.3	20,30	100KHz,0.1V	85	0.88(1.10)	3R3
HCDS3D16T-3R6□	3.6	30	100KHz,0.1V	90	0.74(0.93)	3R6
HCDS3D16T-4R7□	4.7	20,30	100KHz,0.1V	105	0.72(0.90)	4R7
HCDS3D16T-6R8□	6.8	20,30	100KHz,0.1V	170	0.61(0.74)	6R8
HCDS3D16T-100□	10	20,30	100KHz,0.1V	210	0.55(0.60)	100
HCDS3D16T-150□	15	20,30	100KHz,0.1V	295	0.45(0.52)	150
HCDS3D16T-220□	22	20,30	100KHz,0.1V	430	0.32(0.40)	220
HCDS3D16T-270□	27	30	100KHz,0.1V	620	0.30(0.37)	270
HCDS3D16T-330□	33	30	100KHz,0.1V	675	0.26(0.32)	330
HCDS3D16T-680□	68	30	100KHz,0.1V	1700	0.16(0.21)	680

Note: When ordering, please specify tolerance code. Tolerance: M=±20% , T=±30%

- Operating temperature range—30°C~100°C(Including self - temperature rise)
- Isat for Inductance drop 35% from its value with current
- RDC test method: place testing device to the 2 solder ends of winding and test the value.



SMD Shielded Power Inductors - HCDS4D18 Series

HCDS4D18 series Electrical Characteristics

Part No.	Inductance	Tolerance	Test Freq.	RDC(mΩ)	Isat(A)	Marking
	(uH)	(±%)		max	Max(Typ.)	
HCDS4D18T-1R0□	1.0	30	7.96MHz,1V	45	1.72(2.50)	1R0
HCDS4D18T-1R5□	1.5	30	7.96MHz,1V	60	1.50(1.80)	1R5
HCDS4D18T-1R8□	1.8	30	7.96MHz,1V	70	1.35(1.70)	1R8
HCDS4D18T-2R2□	2.2	20,30	7.96MHz,1V	75	1.30(1.60)	2R2
HCDS4D18T-2R7□	2.7	30	7.96MHz,1V	105	1.20(1.50)	2R7
HCDS4D18T-3R3□	3.3	20,30	7.96MHz,1V	110	1.04(1.30)	3R3
HCDS4D18T-3R9□	3.9	30	7.96MHz,1V	155	0.88(1.20)	3R9
HCDS4D18T-4R7□	4.7	30	7.96MHz,1V	162	0.84(1.10)	4R7
HCDS4D18T-5R6□	5.6	30	7.96MHz,1V	170	0.80(1.00)	5R6
HCDS4D18T-6R3□	6.3	30	7.96MHz,1V	180	0.78(0.95)	6R3
HCDS4D18T-6R8□	6.8	20,30	7.96MHz,1V	200	0.76(0.85)	6R8
HCDS4D18T-8R2□	8.2	30	7.96MHz,1V	245	0.68(0.85)	8R2
HCDS4D18T-100□	10	20,30	100KHz,1V	280	0.61(0.75)	100
HCDS4D18T-120□	12	30	100KHz,1V	320	0.56(0.70)	120
HCDS4D18T-150□	15	30	100KHz,1V	360	0.50(0.65)	150
HCDS4D18T-180□	18	30	100KHz,1V	400	0.48(0.60)	180
HCDS4D18T-220□	22	20,30	100KHz,1V	480	0.41(0.55)	220
HCDS4D18T-270□	27	30	100KHz,1V	570	0.35(0.50)	270
HCDS4D18T-330□	33	30	100KHz,1V	694	0.32(0.45)	330
HCDS4D18T-390□	39	30	100KHz,1V	800	0.30(0.40)	390
HCDS4D18T-470□	47	30	100KHz,1V	950	0.28(0.38)	470
HCDS4D18T-560□	56	30	100KHz,1V	1080	0.26(0.35)	560
HCDS4D18T-680□	68	30	100KHz,1V	1300	0.24(0.34)	680
HCDS4D18T-101□	100	30	100KHz,1V	2000	0.20(0.30)	101

Note: When ordering, please specify tolerance code. Tolerance: M=±20% , T=±30%

- Operating temperature range—30℃~100℃(Including self - temperature rise)
- Isat for Inductance drop 35% from its value with current
- RDC test method: place testing device to the 2 solder ends of winding and test the value.



SMD Shielded Power Inductors - HCDS4D28 Series

HCDS4D28 series Electrical Characteristics

Part No.	Inductance	Tolerance	Test Freq.	RDC(mΩ)	Rated Current	Marking
	(uH)	(±%)		max	(A)	
HCDS4D28T-1R2□	1.2	30	100KHz,1V	23.6	2.56	1R2
HCDS4D28T-1R8□	1.8	30	100KHz,1V	27.5	2.20	1R8
HCDS4D28T-2R0□	2.0	30	100KHz,1V	29.0	2.10	2R0
HCDS4D28T-2R2□	2.2	30	100KHz,1V	31.3	2.04	2R2
HCDS4D28T-2R7□	2.7	30	100KHz,1V	43.3	1.60	2R7
HCDS4D28T-3R3□	3.3	30	100KHz,1V	49.2	1.57	3R3
HCDS4D28T-3R9□	3.9	30	100KHz,1V	64.8	1.44	3R9
HCDS4D28T-4R7□	4.7	30	100KHz,1V	72.0	1.32	4R7
HCDS4D28T-5R6□	5.6	30	100KHz,1V	100.9	1.17	5R6
HCDS4D28T-6R8□	6.8	30	100KHz,1V	108.9	1.12	6R8
HCDS4D28T-8R2□	8.2	30	100KHz,1V	117.5	1.04	8R2
HCDS4D28T-100□	10	20,30	100KHz,1V	128.3	1.00	100
HCDS4D28T-120□	12	20,30	100KHz,1V	131.6	0.84	120
HCDS4D28T-150□	15	20,30	100KHz,1V	149	0.76	150
HCDS4D28T-180□	18	20,30	100KHz,1V	166	0.72	180
HCDS4D28T-220□	22	20,30	100KHz,1V	235	0.70	220
HCDS4D28T-270□	27	20,30	100KHz,1V	261	0.58	270
HCDS4D28T-330□	33	20,30	100KHz,1V	331.3	0.56	330
HCDS4D28T-390□	39	20,30	100KHz,1V	383.7	0.50	390
HCDS4D28T-470□	47	20,30	100KHz,1V	587	0.48	470
HCDS4D28T-560□	56	20,30	100KHz,1V	624.5	0.41	560
HCDS4D28T-680□	68	20,30	100KHz,1V	699	0.35	680
HCDS4D28T-820□	82	20,30	100KHz,1V	914.8	0.32	820
HCDS4D28T-101□	100	20,30	100KHz,1V	1020	0.29	101
HCDS4D28T-121□	120	20,30	100KHz,1V	1270	0.27	121
HCDS4D28T-151□	150	20,30	100KHz,1V	1350	0.24	151
HCDS4D28T-181□	180	20,30	100KHz,1V	1540	0.22	181
HCDS4D28T-221□	220	20,30	100KHz,1V	2000	0.20	221
HCDS4D28T-331□	330	20,30	100KHz,1V	3400	0.19	331
HCDS4D28T-391□	390	20,30	100KHz,1V	3560	0.18	391
HCDS4D28T-681□	680	20,30	100KHz,1V	5200	0.10	681

Note: When ordering, please specify tolerance code. Tolerance: M=±20% , T=±30%

- Operating temperature range—30℃~100℃(Including self - temperature rise)
- Isat for Inductance drop 35% from its value with current
- RDC test method: place testing device to the 2 solder ends of winding and test the value.



SMD Shielded Power Inductors - HCDS4D40 Series

HCDS4D40 series Electrical Characteristics

Part No.	Inductance (μ H)	Tolerance (\pm %)	Test Freq.	RDC(m Ω) max	Rated Current (A)	Marking
HCDS4D40T-2R2□	2.2	30	100KHz, 1V	22	4.60	2R2
HCDS4D40T-3R3□	3.3	30	100KHz, 1V	33	3.40	3R3
HCDS4D40T-4R7□	4.7	30	100KHz, 1V	44	2.80	4R7
HCDS4D40T-6R8□	6.8	30	100KHz, 1V	46	2.60	6R8
HCDS4D40T-100□	10	20,30	100KHz, 1V	150	1.80	100
HCDS4D40T-150□	15	20,30	100KHz, 1V	210	1.60	150
HCDS4D40T-220□	22	20,30	100KHz, 1V	270	1.40	220

Note: When ordering, please specify tolerance code. Tolerance: M=±20% , T=±30%

- Operating temperature range —30°C ~ 100°C (Including self - temperature rise)
- Isat for Inductance drop 35% from its value with current
- RDC test method: place testing device to the 2 solder ends of winding and test the value.

**SMD Shielded Power Inductors - HCDS5D18 Series****HCDS5D18 series Electrical Characteristics**

Part No.	Inductance (uH)	Tolerance (±%)	Test Freq.	RDC(mΩ) max	Rated Current (A)	Marking
HCDS5D18T-1R0□	1.0	30	10KHz,1V	38	2.80	1R0
HCDS5D18T-1R5□	1.5	30	10KHz,1V	38	2.50	1R5
HCDS5D18T-2R0□	2.0	30	10KHz,1V	45	2.50	2R0
HCDS5D18T-2R2□	2.2	30	10KHz,1V	48	1.90	2R2
HCDS2D18T-3R3□	3.3	30	10KHz,1V	56	1.90	3R3
HCDS5D18T-4R1□	4.1	30	10KHz,1V	57	1.95	4R1
HCDS2D18T-4R7□	4.7	30	10KHz,1V	76	1.60	4R7
HCDS5D18T-5R4□	5.4	30	10KHz,1V	76	1.60	5R4
HCDS2D18T-6R2□	6.2	30	10KHz,1V	96	1.40	6R2
HCDS5D18T-6R8□	6.8	30	10KHz,1V	100	1.35	6R8
HCDS2D18T-8R9□	8.9	30	10KHz,1V	116	1.25	8R9
HCDS5D18T-100□	10	20,30	10KHz,1V	124	1.20	100
HCDS2D18T-120□	12	20,30	10KHz,1V	153	1.10	120
HCDS5D18T-150□	15	20,30	10KHz,1V	196	0.97	150
HCDS2D18T-180□	18	20,30	10KHz,1V	210	0.85	180
HCDS5D18T-220□	22	20,30	10KHz,1V	290	0.80	220
HCDS2D18T-270□	27	20,30	10KHz,1V	330	0.75	270
HCDS5D18T-330□	33	20,30	10KHz,1V	386	0.65	330
HCDS2D18T-390□	39	20,30	10KHz,1V	520	0.57	390
HCDS5D18T-470□	47	20,30	10KHz,1V	595	0.54	470
HCDS2D18T-560□	56	20,30	10KHz,1V	665	0.50	560
HCDS5D18T-680□	68	20,30	10KHz,1V	840	0.43	680
HCDS2D18T-820□	82	20,30	10KHz,1V	978	0.41	820
HCDS5D18T-101□	100	20,30	10KHz,1V	1200	0.36	101

Note: When ordering, please specify tolerance code. Tolerance: M=±20% , T=±30%

- Operating temperature range -30℃ ~ 100℃ (Including self - temperature rise)
- Isat for Inductance drop 35% from its value with current
- RDC test method: place testing device to the 2 solder ends of winding and test the value.



SMD Shielded Power Inductors - HCDS5D28 Series

HCDS5D28 series Electrical Characteristics

Part No.	Inductance	Tolerance	Test Freq.	RDC(mΩ)	Rated Current	Marking
	(uH)	(±%)		max	(A)	
HCDS5D28T-1R0□	1.0	30	10KHz,1V	15	3.50	1R0
HCDS5D28T-1R5□	1.5	30	10KHz,1V	15	3.00	1R5
HCDS5D28T-2R2□	2.2	30	10KHz,1V	18	2.60	2R2
HCDS5D28T-2R5□	2.5	30	10KHz,1V	18	2.60	2R5
HCDS5D28T-2R6□	2.6	30	10KHz,1V	22	2.40	2R6
HCDS5D28T-2R7□	2.7	30	10KHz,1V	24	2.40	2R7
HCDS5D28T-3R0□	3.0	30	10KHz,1V	24	2.40	3R0
HCDS5D28T-3R3□	3.3	30	10KHz,1V	27	2.10	3R3
HCDS5D28T-4R2□	4.2	30	10KHz,1V	31	2.20	4R2
HCDS5D28T-4R3□	4.3	30	10KHz,1V	41	2.10	4R3
HCDS5D28T-4R7□	4.7	30	10KHz,1V	38	1.90	4R7
HCDS5D28T-5R0□	5.0	30	10KHz,1V	38	1.90	5R0
HCDS5D28T-5R3□	5.3	30	10KHz,1V	38	1.90	5R3
HCDS5D28T-6R2□	6.2	30	10KHz,1V	45	1.80	6R2
HCDS5D28T-6R8□	6.8	30	10KHz,1V	50	1.65	6R8
HCDS5D28T-8R2□	8.2	30	10KHz,1V	53	1.60	8R2
HCDS5D28T-100□	10	20,30	10KHz,1V	65	1.30	100
HCDS5D28T-120□	12	20,30	10KHz,1V	76	1.20	120
HCDS5D28T-150□	15	20,30	10KHz,1V	103	1.10	150
HCDS5D28T-180□	18	20,30	10KHz,1V	110	1.00	180
HCDS5D28T-220□	22	20,30	10KHz,1V	122	0.90	220
HCDS5D28T-270□	27	20,30	10KHz,1V	175	0.85	270
HCDS5D28T-330□	33	20,30	10KHz,1V	189	0.75	330
HCDS5D28T-390□	39	20,30	10KHz,1V	212	0.70	390
HCDS5D28T-470□	47	20,30	10KHz,1V	250	0.62	470
HCDS5D28T-560□	56	20,30	10KHz,1V	305	0.58	560
HCDS5D28T-680□	68	20,30	10KHz,1V	355	0.52	680
HCDS5D28T-820□	82	20,30	10KHz,1V	463	0.46	820

Note: When ordering, please specify tolerance code. Tolerance: M=±20% , T=±30%

- Operating temperature range—30℃~100℃(Including self - temperature rise)
- Isat for Inductance drop 35% from its value with current
- RDC test method: place testing device to the 2 solder ends of winding and test the value.



SMD Shielded Power Inductors - HCDS5D28 Series

HCDS5D28 series Electrical Characteristics

Part No.	Inductance (uH)	Tolerance (±%)	Test Freq.	RDC(mΩ) max	Rated Current (A)	Marking
HCDS5D28T-101□	100	20,30	10KHz,1V	520	0.42	101
HCDS5D28T-181□	180	20,30	10KHz,1V	1050	0.29	181
HCDS5D28T-221□	220	20,30	10KHz,1V	1200	0.28	221
HCDS5D28T-331□	330	20,30	10KHz,1V	1700	0.19	331
HCDS5D28T-391□	390	20,30	10KHz,1V	1800	0.18	391
HCDS5D28T-471□	470	20,30	10KHz,1V	2500	0.15	471
HCDS5D28T-561□	560	20,30	10KHz,1V	3200	0.12	561

Note: When ordering, please specify tolerance code. Tolerance: M=±20% , T=±30%

- Operating temperature range -30°C ~ 100°C (Including self - temperature rise)
- Isat for Inductance drop 35% from its value with current
- RDC test method: place testing device to the 2 solder ends of winding and test the value.



SMD Shielded Power Inductors - HCDS6D28 Series

HCDS6D28 series Electrical Characteristics

Part No.	Inductance (uH)	Tolerance (±%)	Test Freq.	RDC(mΩ) max	Rated Current (A)	Marking
HCDS6D28T-1R0□	1.0	30	10KHz,1V	24	3.50	1R0
HCDS6D28T-1R5□	1.5	30	10KHz,1V	19.5	3.40	1R5
HCDS6D28T-3R0□	3.0	30	10KHz,1V	24	3.00	3R0
HCDS6D28T-3R3□	3.3	30	10KHz,1V	25	3.00	3R3
HCDS6D28T-3R9□	3.9	30	10KHz,1V	27	2.60	3R9
HCDS6D28T-4R7□	4.7	30	10KHz,1V	31	2.40	4R7
HCDS6D28T-5R0□	5.0	30	10KHz,1V	31	2.40	5R0
HCDS6D28T-6R0□	6.0	30	10KHz,1V	35	2.25	6R0
HCDS6D28T-6R2□	6.2	30	10KHz,1V	51	2.40	6R2
HCDS6D28T-6R8□	6.8	30	10KHz,1V	50	2.15	6R8
HCDS6D28T-7R3□	7.3	30	10KHz,1V	54	2.10	7R3
HCDS6D28T-8R6□	8.6	30	10KHz,1V	58	1.85	8R6
HCDS6D28T-100□	10	20,30	10KHz,1V	65	1.70	100
HCDS6D28T-120□	12	20,30	10KHz,1V	70	1.55	120
HCDS6D28T-150□	15	20,30	10KHz,1V	84	1.40	150
HCDS6D28T-180□	18	20,30	10KHz,1V	95	1.32	180
HCDS6D28T-220□	22	20,30	10KHz,1V	128	1.20	220
HCDS6D28T-270□	27	20,30	10KHz,1V	142	1.05	270
HCDS6D28T-330□	33	20,30	10KHz,1V	165	0.97	330
HCDS6D28T-390□	39	20,30	10KHz,1V	210	0.86	390
HCDS6D28T-470□	47	20,30	10KHz,1V	238	0.80	470
HCDS6D28T-560□	56	20,30	10KHz,1V	277	0.73	560
HCDS6D28T-680□	68	20,30	10KHz,1V	304	0.65	680
HCDS6D28T-820□	82	20,30	10KHz,1V	390	0.60	820
HCDS6D28T-101□	100	20,30	10KHz,1V	535	0.54	101
HCDS6D28T-121□	120	20,30	10KHz,1V	600	0.40	121
HCDS6D28T-221□	220	20,30	10KHz,1V	1300	0.30	221

Note: When ordering, please specify tolerance code. Tolerance: M=±20% , T=±30%

- Operating temperature range—30℃~100℃(Including self - temperature rise)
- Isat for Inductance drop 35% from its value with current
- RDC test method: place testing device to the 2 solder ends of winding and test the value.

**SMD Shielded Power Inductors - HCDS6D38 Series****HCDS6D38 series Electrical Characteristics**

Part No.	Inductance	Tolerance	Test Freq.	RDC(mΩ)	Rated Current	Marking
	(uH)	(±%)		max	(A)	
HCDS6D38T-2R2□	2.2	30	10KHz,0.1V	18	3.80	2R2
HCDS6D38T-2R7□	2.7	30	10KHz,0.1V	20	3.60	2R7
HCDS6D38T-3R3□	3.3	30	10KHz,0.1V	20	3.50	3R3
HCDS6D38T-4R7□	4.7	30	10KHz,0.1V	22	3.10	4R7
HCDS6D38T-5R0□	5.0	30	10KHz,0.1V	24	2.90	5R0
HCDS6D38T-5R6□	5.6	30	10KHz,0.1V	27	2.50	5R6
HCDS6D38T-6R2□	6.2	30	10KHz,0.1V	27	2.50	6R2
HCDS6D38T-6R8□	6.8	30	10KHz,0.1V	31	2.30	6R8
HCDS6D38T-7R4□	7.4	30	10KHz,0.1V	31	2.30	7R4
HCDS6D38T-8R7□	8.7	30	10KHz,0.1V	34	2.20	8R7
HCDS6D38T-100□	10	20,30	10KHz,0.1V	38	2.00	100
HCDS6D38T-120□	12	20,30	10KHz,0.1V	53	1.70	120
HCDS6D38T-150□	15	20,30	10KHz,0.1V	57	1.60	150
HCDS6D38T-180□	18	20,30	10KHz,0.1V	92	1.50	180
HCDS6D38T-220□	22	20,30	10KHz,0.1V	96	1.30	220
HCDS6D38T-270□	27	20,30	10KHz,0.1V	109	1.20	270
HCDS6D38T-330□	33	20,30	10KHz,0.1V	124	1.10	330
HCDS6D38T-390□	39	20,30	10KHz,0.1V	138	1.00	390
HCDS6D38T-470□	47	20,30	10KHz,0.1V	150	0.95	470
HCDS6D38T-560□	56	20,30	10KHz,0.1V	202	0.85	560
HCDS6D38T-680□	68	20,30	10KHz,0.1V	234	0.75	680
HCDS6D38T-820□	82	20,30	10KHz,0.1V	324	0.70	820
HCDS6D38T-101□	100	20,30	10KHz,0.1V	358	0.65	101
HCDS6D38T-561□	560	20,30	10KHz,0.1V	1800	0.22	561

Note: When ordering, please specify tolerance code. Tolerance: M=±20% , T=±30%

- Operating temperature range—30℃~100℃(Including self - temperature rise)
- Isat for Inductance drop 35% from its value with current
- RDC test method: place testing device to the 2 solder ends of winding and test the value.



SMD Shielded Power Inductors - HCDS8D43 Series

HCDS8D43 series Electrical Characteristics

Part No.	Inductance (uH)	Tolerance (±%)	Test Freq.	RDC(mΩ) max	Rated Current (A)	Marking
HCDS8D43T-3R3□	3.3	20	100KHz,1 V	19	5.70	3R3
HCDS8D43T-4R7□	4.7	20	100KHz,1 V	22	5.60	4R7
HCDS8D43T-6R8□	6.8	20	100KHz,1 V	25	4.40	6R8
HCDS8D43T-100□	10	20	100KHz,1 V	36	4.00	100
HCDS8D43T-150□	15	20	100KHz,1 V	53	2.90	150
HCDS8D43T-220□	22	20	100KHz,1 V	75	2.40	220
HCDS8D43T-470□	47	20	100KHz,1 V	150	1.80	470
HCDS8D43T-680□	68	20	100KHz,1 V	240	1.50	680
HCDS8D43T-101□	100	20	100KHz,1 V	353	1.10	101

Note: When ordering, please specify tolerance code. Tolerance: M=±20%

- Operating temperature range—30℃~100℃(Including self - temperature rise)
- Isat for Inductance drop 35% from its value with current



SMD Shielded Power Inductors - HCDS2D~3D Series

Packaging Specifications

Tape Dimensions

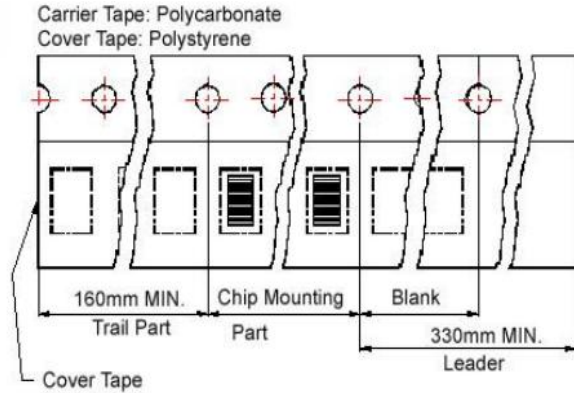
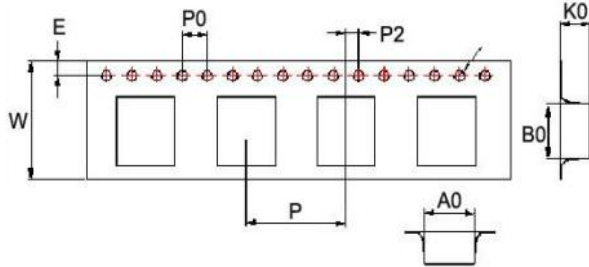

Reel Dimensions

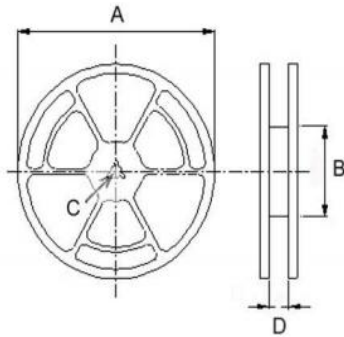

Dimensions in mm

TYPE	Tape Dimensions									Reel Dimensions				Quantity PCS/REEL
	A0	B0	K0	D	E	W	P	P0	P2	A	B	C	D	
HCDS2D11	3.35	3.35	1.40	1.55	1.75	12	8	4	2	178	60	13	13.2	1000
HCDS2D14	3.35	3.35	1.70	1.55	1.75	12	8	4	5	178	60	13	13.2	1000
HCDS2D18	3.50	3.50	2.10	1.55	1.75	12	8	4	2	178	60	13	13.2	1000
HCDS3D11	4.20	4.20	1.50	1.55	1.75	12	8	4	5	178	60	13	13.2	1000
HCDS3D16	4.10	4.10	2.00	1.55	175.00	12	8	4	2	178	60	13	13.2	1000
HCDS3D28	4.20	4.20	3.20	1.55	1.75	12	8	4	5	178	60	13	13.2	500



SMD Shielded Power Inductors - HCDS Series

Packaging Specifications

Tape Dimensions

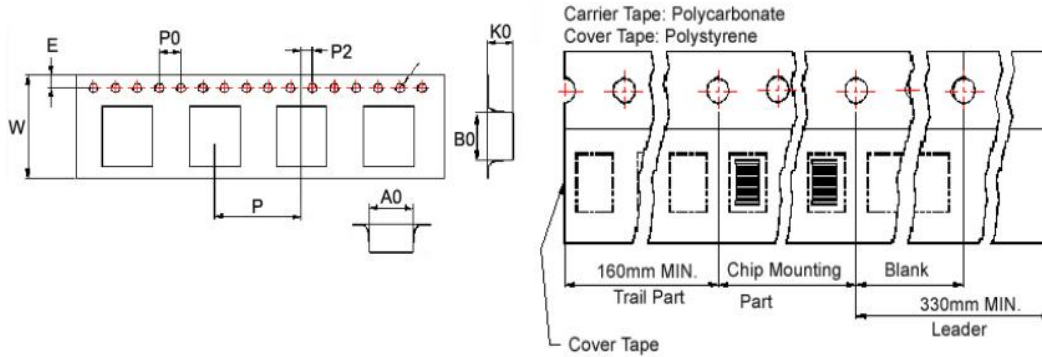

Reel Dimensions

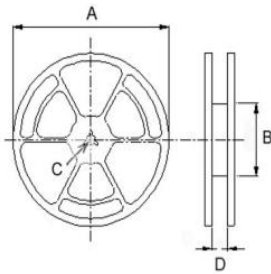

Dimensions in mm

TYPE	Tape Dimensions									Reel Dimensions				Quantity PCS/REEL
	A0	B0	K0	D	E	W	P	P0	P2	A	B	C	D	
HCDS3D16	4.10	4.10	2.00	1.50	1.75	12	8	4	2	178	60	13	13.2	1000
HCDS4D18	5.30	5.30	2.40	1.50	1.75	12	8	4	2	330	100	13	13.4	2000
HCDS4D28	5.30	5.30	3.40	1.50	1.75	12	8	4	2	330	100	13	13.4	2000
HCDS4D40	5.35	5.35	4.10	1.55	1.75	12	8	4	2	330	100	13	13.4	1000
HCDS5D18	6.20	6.20	2.20	1.50	1.75	16	12	4	2	330	100	13	13.4	2000
HCDS5D28	6.20	6.20	3.20	1.50	1.75	16	12	4	2	330	100	13	13.4	2000
HCDS6D28	7.25	7.25	3.35	1.55	1.75	16	12	4	2	330	100	13	16.0	1500
HCDS6D38	7.10	7.10	4.10	1.55	1.75	16	12	4	2	330	100	13	16.0	1000



SMD Shielded Power Inductors - HCDS8D43 Series

Packaging Specifications

Tape Dimensions

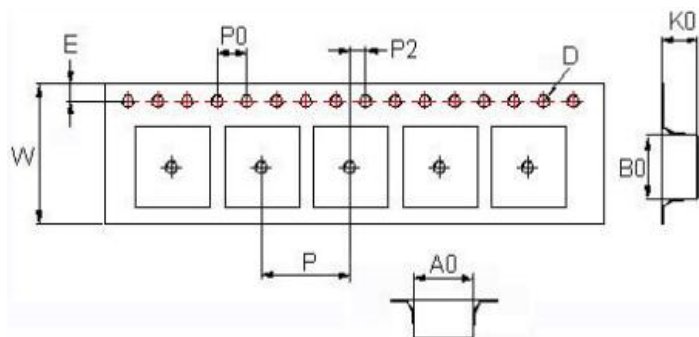

Tape Material

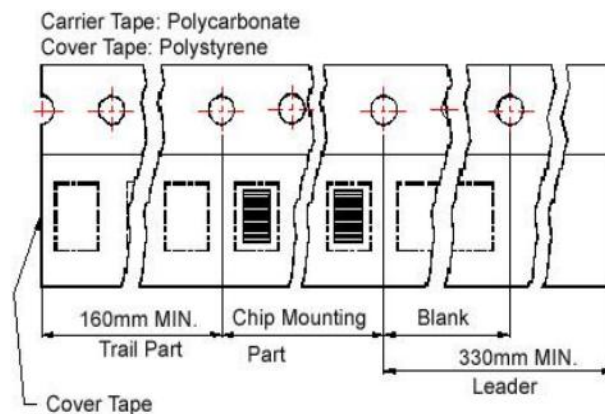

Reel Dimensions

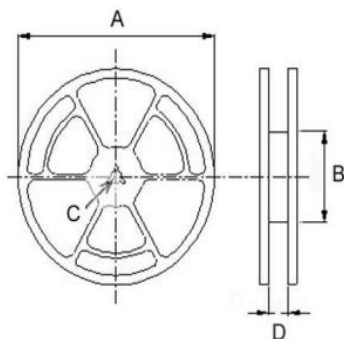

Dimensions in mm

TYPE	Tape Dimensions									Reel Dimensions				Quantity PCS/REEL
	A0	B0	K0	D	E	W	P	P0	P2	A	B	C	D	
HCDS8D43	8.40	9.90	4.80	1.55	1.75	24	12	4	2	330	100	13	24.4	1000